

THIS INFORMATION IS CONFIDENTIAL AND PROPRIETARY TO CW INDUSTRIES INCORPORATED AND ITS AFFILIATES. IT MAY NOT BE DISCLOSED TO ANYONE OTHER THAN CW INDUSTRIES PERSONNEL WITHOUT WRITTEN AUTHORIZATION FROM CW INDUSTRIES INCORPORATED, SOUTHAMPTON, PENNSYLVANIA, USA.

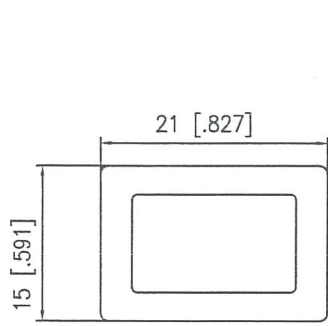

PANEL CUT-OUT		
Z	Y	X
0.7~1.25 [.028~.049]	13.1~13.2 [.515~.520]	19.1~19.2 [.752~.756]
1.25~2.0 [.049~.079]	13.1~13.2 [.515~.520]	19.3~19.4 [.760~.764]
2.0~3.0 [.079~.118]	13.1~13.2 [.515~.520]	19.5~19.6 [.768~.772]

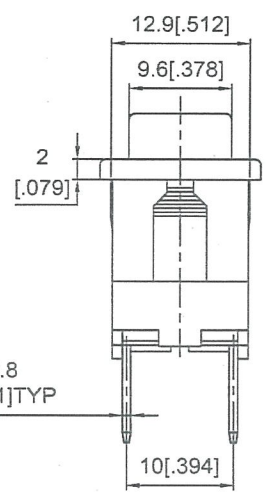
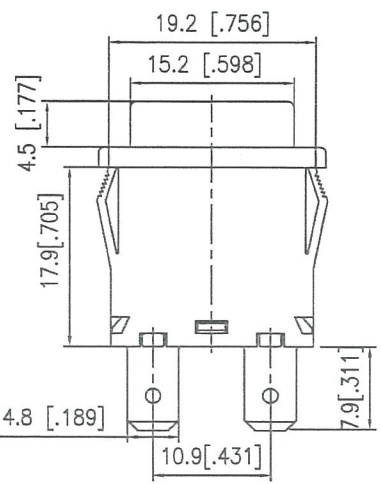
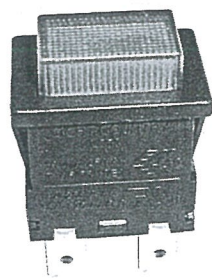

Switch Function Code	Poles & Throws	Pushbutton Down	Pushbutton Up
01	SPST	ON	OFF
02	SPST	(ON)	OFF
03	SPST(w/lamp)	ON	OFF
04	SPST(w/lamp)	(ON)	OFF
05	DPST	ON	OFF
06	DPST	(ON)	OFF
07	DPST(w/lamp)	ON	OFF
08	DPST(w/lamp)	(ON)	OFF

() = Momentary

- All dimensions in mm [inch]
- General tolerance : >10±0.4
<10±0.25
- Electrical rating: 16A 125VAC & 16A 250VAC(UL)
10A(4) 250VAC (VDE.ENEC10)
- Contact resistance : <20mΩ (initial)
- Insulation resistance : >1000 MΩ
(500DC between open contacts)
- Dielectric strength : >1500V 1 minute
- Mechanical life : >30000 cycles
- Electrical life : >10000 cycles
- Temperature rise at the terminal : Max. 30°C
- Soldering of terminal : Max 350°C, 3S (no pressure may be placed in the terminals when soldering by hand).

Marking Chart

•	—				—	△	○	ON
○	=			○	○	▽	○	OFF
A	B	C	D	E	F	G	H	I

* We keep the right to alter a dimension without notice.

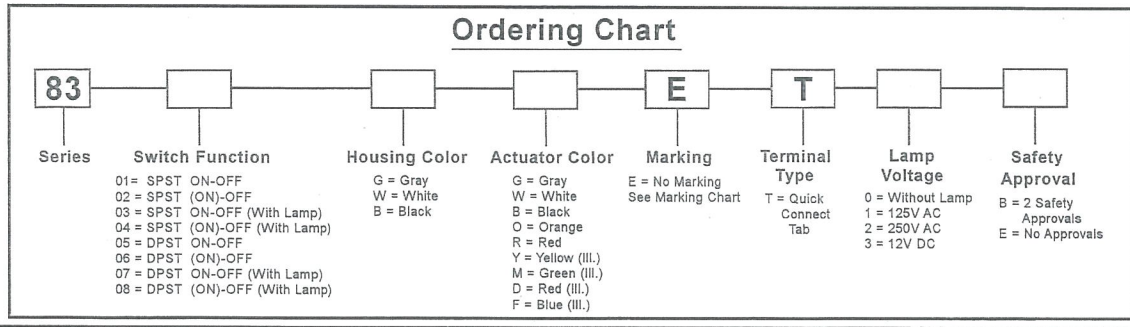

<p>A Unit of Electro Switch Corp.</p> <p>TOLERANCES UNLESS OTHERWISE SPECIFIED</p> <p>2 Place Decimal ± 0.10 METRIC 3 Place Decimal ± 0.05 1 Place Dec ± 25mm Angles ± 1' 2 Place Dec ± .13mm</p>	Title:
	8300 SERIES PUSHBUTTON SWITCHES
Made for: CWIOSLO	Division: SWITCH
Drawn by: DW 3/20/2024	Dwg. No. 8300 SERIES PUSHBUTTON SWITCH
Checked by: <i>[Signature]</i> 3/21/24	
Approval: <i>[Signature]</i> 3/21/24	

1 2 3 4 5 6 7 8 9 10

MASTER